

United States of America
Department of Transportation — Federal Aviation Administration
Supplemental Type Certificate

Number SA2395CE

This certificate, issued to Wilco, Inc.
3502 West Harry
Wichita, KS 67213

certifies that the change in the type design for the following product with the limitations and conditions therefor as specified hereon meets the airworthiness requirements of Part 03 of the Civil Air Regulations.

Original Product — Type Certificate Number: 3A21
Make: Cessna
Model: 210 and T210

Description of Type Design Change: Replacement of pilot/copilot overhead fresh air valves with "WEMAC" type directional control valves in accordance with Wilco, Inc., Drawing W210-100, no revision, dated July 13, 1988, or later FAA approved revisions.

Limitations and Conditions:

None.

This certificate and the supporting data which is the basis for approval shall remain in effect until surrendered, suspended, revoked, or a termination date is otherwise established by the Administrator of the Federal Aviation Administration.

Date of application: July 1, 1988

Date issued:

Date of issuance: August 10, 1988

Date amended:



By direction of the Administrator

Lawrence A. Herron
(Signature)

Lawrence A. Herron, Manager
Wichita Aircraft Certification Office

(Title)

Any alteration of this certificate is punishable by a fine of not exceeding \$1,000, or imprisonment not exceeding 3 years, or both.

This certificate may be transferred in accordance with FAR 21.47.



June 11, 1998

Mr. Everett Pittman
Wichita Aircraft Certification Office
Department of Transportation
Federal Aviation Administration
1801 Airport Road
Mid-Continent Airport
Wichita, Kansas 67209

Attn: Mr. Joel Ligon

RE: STC # SA2395CE

Dear Sirs:

This letter transmits the following data to support a revision to the referenced STC.

- W210-100 Rev (B) Air Distribution Box Instl.-Cabin Vent System / Cessna 210
- W210-101 Rev (A) Air Distribution Box Assy - Fwd Cabin
- W210-103 Rev (-) Air Distribution Box Assy - Aft Cabin
- W210-104 Rev (-) Air Distribution Box Assy - Mid Cabin

8110-3 Form with approval by John Guernsey for all above listed Drawings.

This data shows the expansion of the original STC to cover all the overhead vents in the aircraft. The installation drawings have been expanded to better illustrate the installation. The installation of any one of the outlets or all of the outlets will enhance the performance of the ventilation system.

Sincerely,

John S. Guernsey
President

RECEIVED

JUN 12 1998

THE FAA WICHITA AIRCRAFT CERTIFICATION
OFFICE, ACE-115W, ACKNOWLEDGES RECEIPT AND
 CONCURS WITH APPROVAL
 APPROVES RECOMMENDATION
 FOR COMMENTS SEE FAA LETTER
DATED _____

THIS DATA HAS BEEN ADDED TO OUR FILE

ENGINEER BRANCH DATE

Wichita Aircraft
Certification Office
ACE 115W

116 W
Joel

983579

- ACCEPTS THE APPROVAL
- CONCURS WITH THE RECOMMENDATION
- FOR COMMENTS SEE FAA LETTER

Wilco, INC.

3502 W. Harry
 Wichita, KS 67213
 FAX: (316) 943-9664 TEL: (316) 943-9379

DATED _____
 THIS DATA HAS BEEN ADDED TO OUR FILE

ENGINEER	BRANCH	DATE
<i>M. J. Ambler</i>	<i>116W</i>	<i>1/8/01</i>
<i>D. Ostrowski</i>	<i>118W</i>	<i>1/15/01</i>

December 28, 2001

Federal Aviation Administration
 Central Region
 Wichita Aircraft Certification Office
 1801 Airport Road, Room 100
 Wichita, KS 67209

Attn: Mr. Ronald K. Rathgeber

Subject: Update of STC Data to provide alternate Air Valves and Hoses
 Per drawing W210-100 Rev.(C) on STC SA2395CE for Cessna Models
 210 and T210 Airplanes.

Dear Mr. Rathgeber:

Enclosed are the following items:

1. (2) FAA Form 8110-3 dated December 6, 2001, signed by Donald E. Shepherd for Structures and John Provorse for Systems & Equipment.
 (2) originals.
2. Drawing:
 W210-100 Rev.(C) Sht. 1 thru 4, Air Distribution Box Instl. Cabin Vent System /Cessna 210.
 (2) copies.
 AV151102 Rev.(B) Air Valve, Disc Type, .875 ID, (Birk Aerosystems)
 IT-5886 Rev.(-) Sleeve, (Industrial Tube Corporation)
 IT-5887 Rev.(-) Sleeve, (Industrial Tube Corporation)
 IT-5888 Rev.(-) Sleeve, (Industrial Tube Corporation)
 (1) copy each.
3. Reports:
 Burn Test Reports supplied by vendor, Industrial Tube Corporation.
 (1) copy each.

Please return one FAA stamped copy of the (4) sheets of Drawing W210-100 Rev.(C). Thank You.

If you have any questions, please contact our office or Joe Dwerlkotte at (316) 263-4217 ext 15.

Sincerely,
Wilco, Inc.

Charles Nelson
Project Manager

Enclosures

Cc: J.B. Dwerlkotte Associates, Inc. Professional Engineers.
01-651

116WME -
118W -

WICHITA ACO
 73-2002-117W Nero
 2002 JAN -4 PM 12:26



WILCO, INC.
Serving the Aircraft Industry Since 1953



3502 W. HARRY
WICHITA, KS 67213

PHONE (316) 943-9379
FAX (316) 943-9664
WATTS (800) 767-7593

EMAIL:
sales@wilco.to

January 9, 2004

Mr. Ronald K. Rathgeber
Wichita Aircraft Certification Office
Department of Transportation
Federal Aviation Administration
1801 Airport Road
Mid Continent Road
Wichita, Ks. 67209

RECEIPT OF MINOR CHANGES *Approved*
DATE *7 Feb 04* INITIAL/SIB. *MDP*
REFERENCE DATA ON FILE
FAA WICHITA AIRCRAFT CERTIFICATION OFFICE
WICHITA, KANSAS

REC'D FEB 06 2004

Dear Mr. Rathgeber.

I met with Mr. Harvey Nero, Mr. Gary Park, and Mr. Mike Imbler Monday, November 24, 2003 for discussion and review of the referenced STC. This STC SA2395CE is for the vent system of Cessna 210 and T210 aircraft. I believe all of the above people agreed that this request for revision was a minor change.

It appears that many of the Cessna 210's built prior to 1978 used whatever vent tubing was available. Our STC vent system uses 2 inch vent tubing and the older models could and did use 1 1/2 inch vent tubing. The tubing company that supply our vent tubing has made a reducer part # IT-5970-1 to accommodate these aircraft. The reducer will enable the owners or mechanic to match up the smaller tube with the larger tubing contained in our STC kit. Of course this reducer is provided if needed otherwise the customer can disregard. It would be our intention to add two to each kit. If used they would only apply to the front vent assembly.

Many requests from customers are the driving force for this request for revision. This Wilco STC kit is far superior to the OEM installation. It allows more air to move, focused air control, positive shut off, better directional control, and full/partial closure.

Thank you in advance for this consideration.

Best regards,
Charles A. Nelson
Charles A. Nelson
VP Marketing & Sales

116 Wm M Imbler
118 Wa G Park

RECEIVED
WICHITA ACO
109-2004-1720 Nero
2004 JAN -9 A 9:36

C (-3 AFT CABIN VENT INSTL)

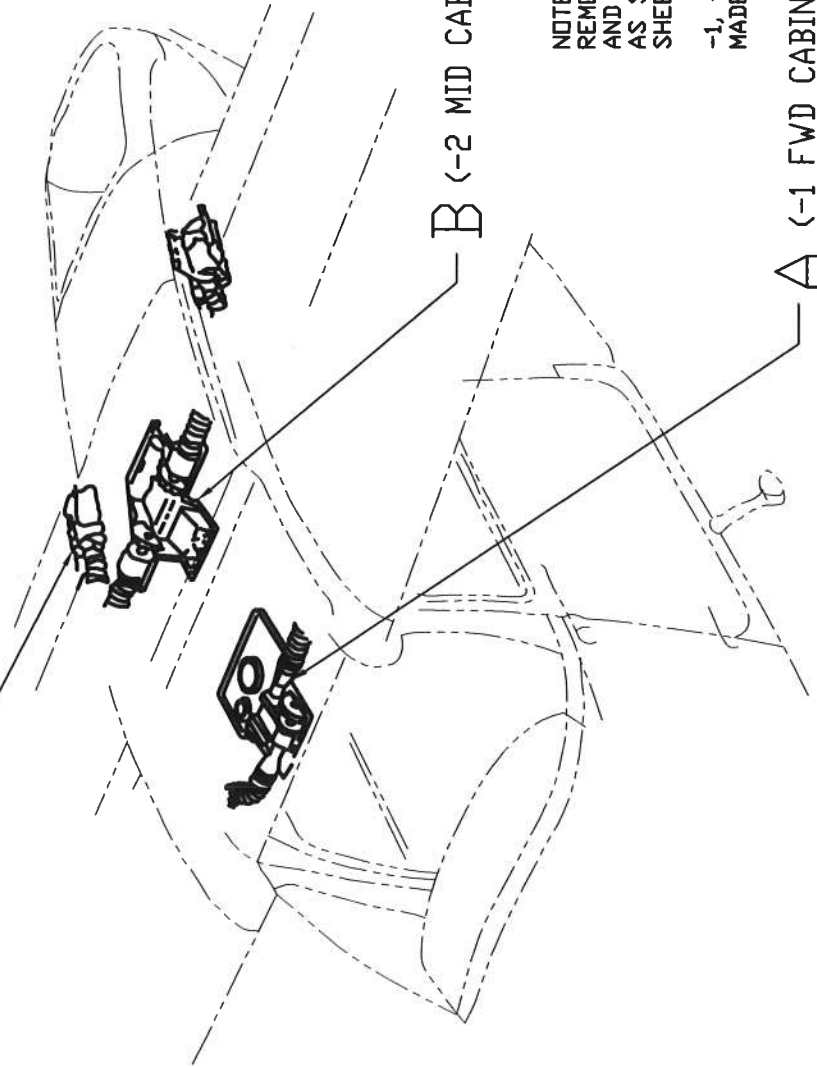

B (-2 MID CABIN VENT INSTL)

A (-1 FWD CABIN VENT INSTL)

NOTE:
REMOVE EXISTING VENT CONTROLS
AND REPLACE WITH WILCO PARTS
AS SPECIFIED ON FOLLOWING
SHEETS.

-1, -2 OR -3 INSTL'S MAY BE
MADE TOGETHER OR INDIVIDUALLY

WEMAC = B/E AEROSPACE
75 BEACON DR.
HOLBROOK, NY 11741

BIRK = BIRK AEROSYSTEMS CORPORATION
7522 SLATER AVENUE, UNIT 116
HUNTINGTON BEACH, CA 92647

HBD = HBD INDUSTRIES
201 N. ALLEN STREET
CHANUTE, KS 66720

TUBE = INDUSTRIAL TUBE CORPORATION
3091 INDIAN AVENUE
PERRIS, CA 92570

INCH		Tolerances Except as noted: Fractional = ±1/16 .X = ±.1 .XX = ±.05 .XXX = ±.010 Angular = ±2	
WILCO INC.		3502 W Harry Wichita, KS 67213	
CONTRACT TITLE		AIR DISTRIBUTION BOX INSTL. CABIN VENT SYSTEM / CESSNA 210	
ISSUED	NONE	ISSUED BY	DALE
REVISED	B	REVISED BY	DALE
DRAWING NUMBER		W210-100	
SHEET		1 of 4	

REV	DESCRIPTION	DATE	BY	APPD
B	EXISTING TUBE SUPPLIED BY CESSNA IS LAMP DIMENSIONS AND ASSEMBLY INSTRUCTIONS. REVISED BY WEMAC.			
C	REVISED PART CALLOUTS AND VENT & INSTL. DETAILS. REVISED BY WEMAC.			
A	REVISED & REWASHER ASSEMBLY. REVISED BY WEMAC.			
	EXPANDED INSTL. INSTRUCTIONS FOR CLARITY.			

REMOVE ORIGINAL VENT HARDWARE

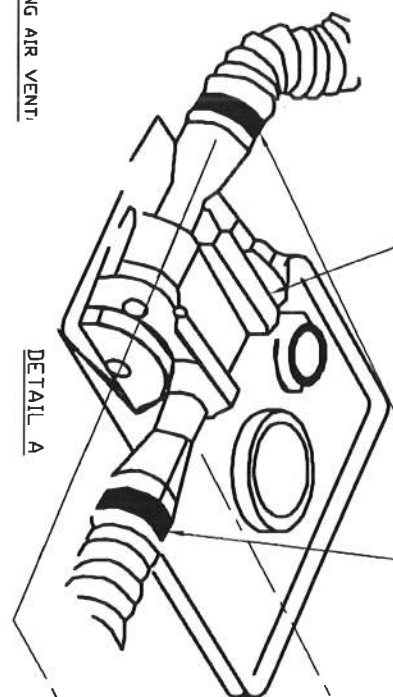

REMOVE EXISTING AIR VENT:

BEFORE INSTALLATION OF THE W210-101-26 AIR BOX CAN BEGIN, THE EXISTING AIR VENT MUST BE REMOVED. TO GAIN ACCESS TO THE VENT, REMOVE THE OVERHEAD ROYALITE COVER, SUN VISOR AND FRONT OVERHEAD AIR VENT PANEL. DISCONNECT THE SCAT HOSE FROM THE EXISTING VENTS. PULL ON THE AIR ADJUSTMENT KNOB TO REMOVE THE OUTER TUBE ASSY FROM ITS HOUSING. THIS WILL EXPOSE THE SIX RIVETS THAT ATTACH THE EXISTING HOUSING TO THE UPPER STRINGERS. DRILL OUT THESE SIX EXISTING RIVETS USING STANDARD SHOP PRACTICES.

DETAIL A

INSTALLING THE NEW VENT BOX (W210-101-26)

REMOVE THE WEMAC AIR VENTS AND MOUNTING PLATE FROM THE ASSEMBLED W210-101-26 UNIT. TRIM THE ROYALITE COVER OUT IN THE AREA WHERE THE ORIGINAL AIR VENTS WERE LOCATED. THE NEATER THE TRIM, THE CLEANER THE INSTALLATION WILL APPEAR. PLACE THE NEW BOX ASSEMBLY WHERE THE PREVIOUS BOX WAS REMOVED. ATTACH THE EXISTING SCAT HOSE TO EACH END OF THE SCAT HOSE ON EACH END OF THE BOX USING THE SLEEVE TUBE AND CLAMPS PROVIDED. IF ORIGINAL OR EXISTING HOSE IS 1 1/2", USE REDUCER IT-59701-1 TO COMPLETE THE FIT. THE EXISTING SCAT HOSE SLIDES OVER THE SLEEVE IN THE END OF THE SCAT HOSE ATTACHED TO THE BOX. THE HOSE PROVIDED CAN BE TRIMMED TO MATCH THE ORIGINAL INSTALLATION. PLACE THE MOUNTING PLATE IN POSITION AND MARK WHERE THE TWO EXISTING RIVET HOLES ARE LOCATED. USING A #20 DRILL, DRILL A HOLE IN THE PLATE AT EACH OF THESE TWO POSITIONS. USE INCL TWO #8-32 FLUSH SCREWS. TEMPORARILY ATTACH THE MOUNTING PLATE, PENETRATING BOTH THE PLATE AND THE MATING FLANGE OF THE EXISTING STRINGER. DETACH THE MOUNTING PLATE AND DRILL OUT THE PILOT HOLES TO 5/32" DIA. SCREW THE WEMAC VENTS INTO THE PLATE HAND TIGHT. REMOVE THE PLATE TO THE STRUCTURE USING FOUR #6X1/2 SELF TAPPING SCREWS. REASSEMBLE THE ROYALITE COVER AND SUNVISORS.

USE P/N IT-5970-1 (PART NO. FROM INDUSTRIAL TUBE CORPORATION) REDUCER IF 1 1/2" TUBE WAS SUPPLIED BY CESSNA

AIR VENT VALVE (2 REQD)
055-0915-04001 P/N WEMAC
OPTION
AV 151102 P/N BIRK

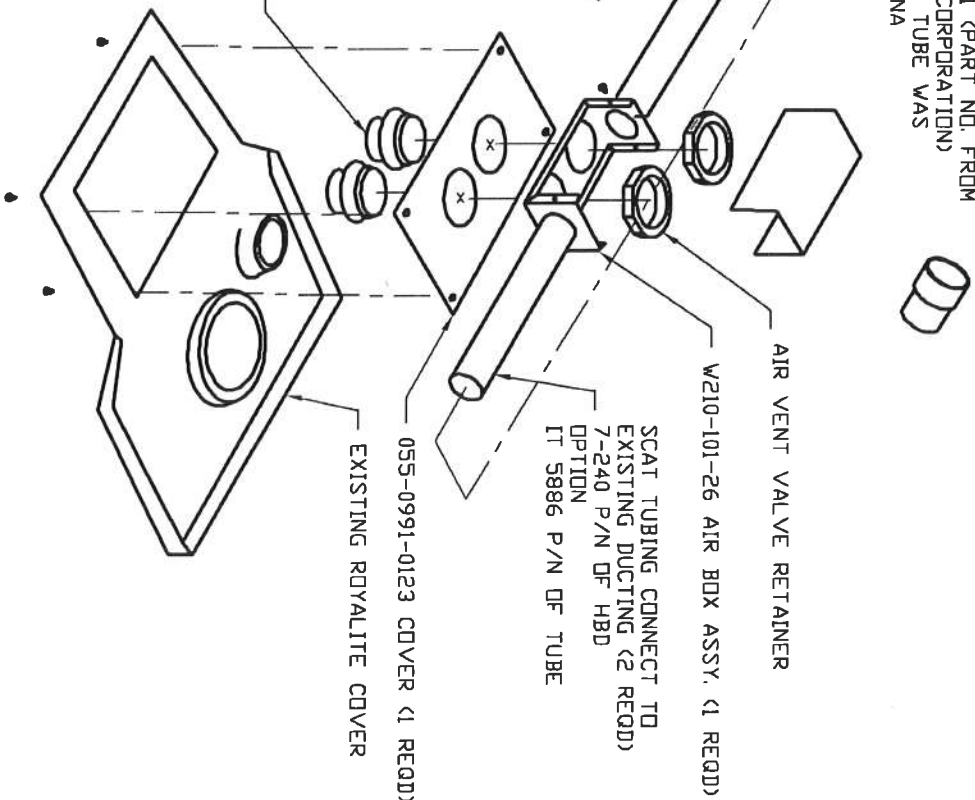

-1 FWD CABIN VENT INSTL.

REV	DATE	BY	APP'D
0	22DEC03	BT	PPD

<p>INCH</p> <p>Tolerances: Except as noted: Fractional = ±1/16 .X = ±.1 .XX = ±.05 .XXX = ±.010 Angular = ±Z</p>		<p>3502 W Harry Wichita, KS 67213</p> <p>WILCO INC.</p> <p>Ordering Title: AIR DISTRIBUTION BOX INSTL CABIN VENT SYSTEM / CESSNA 210</p> <p>Ordering Number: W210-100</p>	
REV	DATE	BY	APP'D
0	22DEC03	BT	PPD

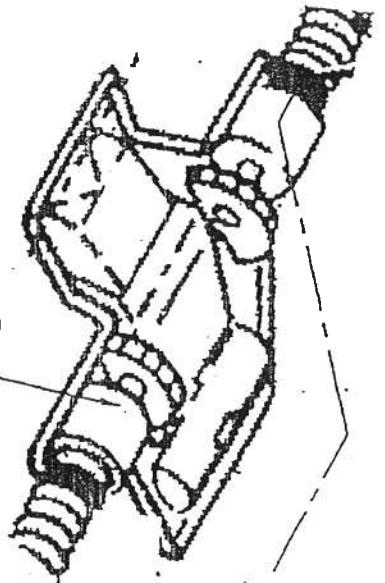

DETAIL B REMOVE EXISTING VENTS

REMOVE EXISTING AIR VENT.

BEFORE INSTALLATION OF THE W210-104-1 AIR BOX CAN BEGIN, THE EXISTING AIR VENT MUST BE REMOVED. TO GAIN ACCESS TO THE VENT, REMOVE THE OVERHEAD ROYALITE COVER. DISCONNECT THE SCAT HOSE FROM THE EXISTING VENTS. PULL ON THE AIR ADJUSTMENT KNOB TO REMOVE THE OUTER TUBE ASSY FROM IT'S HOUSING. THIS WILL EXPOSE THE ORIGINAL VENT SUPPORT STRUCTURE. BEND AND FILE ORIGINAL FLANGES TO ALLOW CLEARANCE FOR NEW AIR CONTROL BOX.

INSTALLING THE NEW VENT BOX (W210-104-1)

REMOVE THE WEMAC AIR VENTS AND MOUNTING PLATE FROM THE ASSEMBLED W210-104-1 UNIT. TRIM THE ROYALITE COVER OUT IN THE AREA WHERE THE ORIGINAL AIR VENTS WERE LOCATED. THE NEATER THE TRIM, THE CLEANER THE INSTALLATION WILL APPEAR. PLACE THE NEW BOX ASSEMBLY WHERE THE PREVIOUS BOX ASSEMBLY WAS REMOVED. ATTACH THE EXISTING SCAT HOSE TO EACH END OF THE SCAT HOSE ON EACH END OF THE BOX USING THE SLEEVE TUBE AND CLAMPS PROVIDED. THE EXISTING SCAT HOSE SLIDES OVER THE SLEEVE IN THE END OF THE SCAT HOSE ATTACHED TO THE BOX. THE HOSE PROVIDED CAN BE TRIMMED TO MATCH THE ORIGINAL INSTALLATION. PLACE THE MOUNTING PLATE IN POSITION AND MARK WHERE THE TWO EXISTING ROYALITE MOUNTING HOLES ARE LOCATED. MARK THE ROYALITE ATTACH SCREW HOLES AND DRILL THE PLATE TO MATCH. REINSTALL THE ROYALITE COVER AND MOUNTING STRUCTURE.

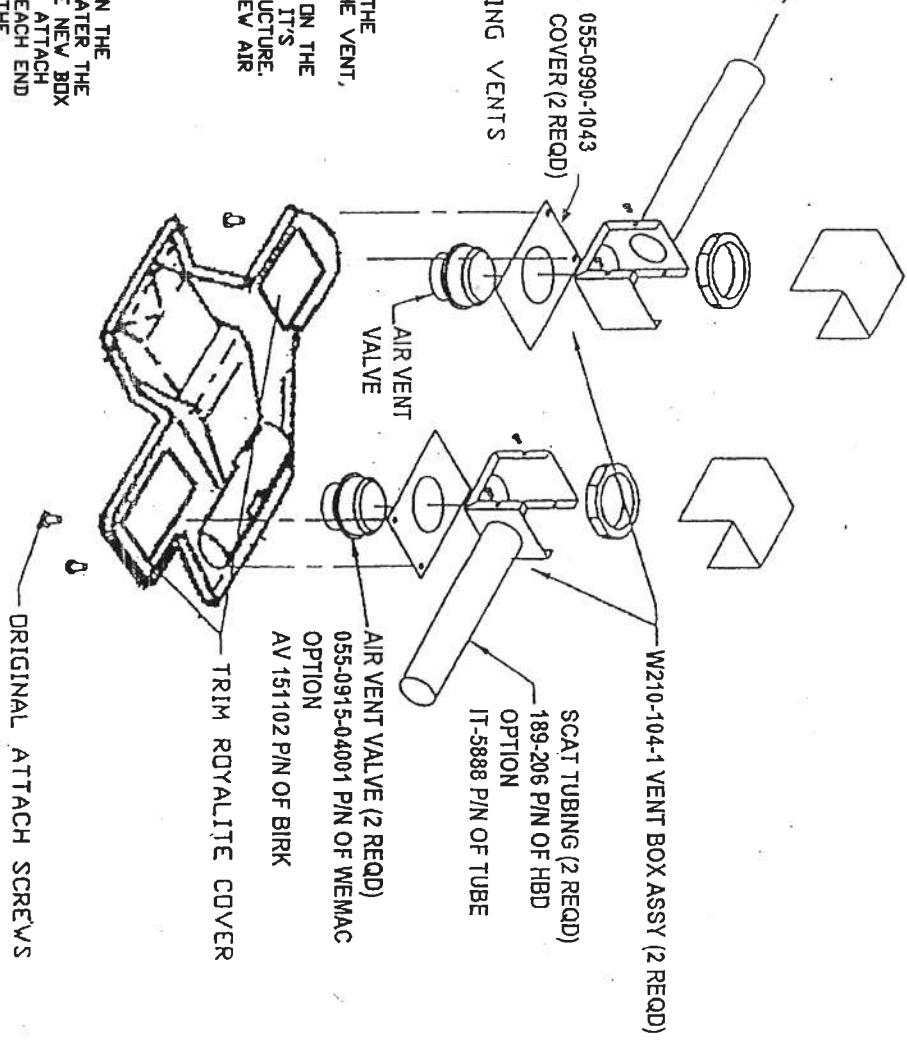

-2 MID CABIN VENT INSTL.

<p>INCH</p> <p>Tolerances Except as noted Fractional = 1/16 .X = ±.1 .XX = ±.05 XXX = ±.010 Angular = ±2°</p>		<p>WILCO INC.</p> <p>3502 W Harry Wichita, KS 67213</p>	
<p>REV 1</p> <p>DATE</p> <p>BY</p> <p>APP'D</p>	<p>REV 2</p> <p>DATE</p> <p>BY</p> <p>APP'D</p>	<p>REV 3</p> <p>DATE</p> <p>BY</p> <p>APP'D</p>	<p>REV 4</p> <p>DATE</p> <p>BY</p> <p>APP'D</p>
<p>DRIVING TITLE</p> <p>AIR DISTRIBUTION BOX INSTL CABIN VENT SYSTEM / CESSNA 210</p>		<p>W210-100</p>	
<p>3 of 4</p>		<p>3 of 4</p>	

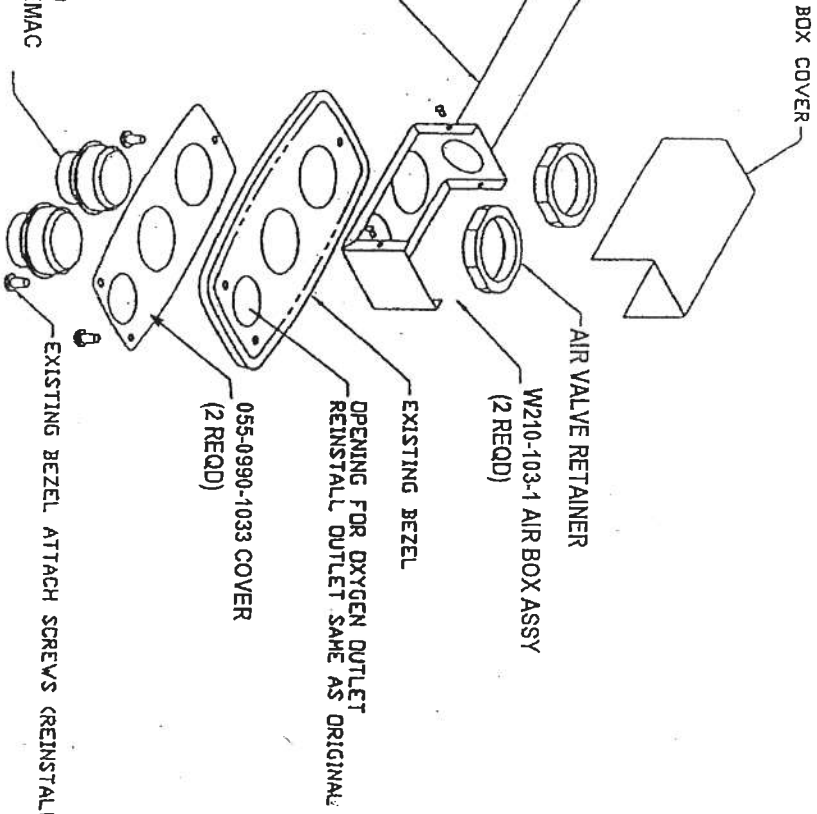
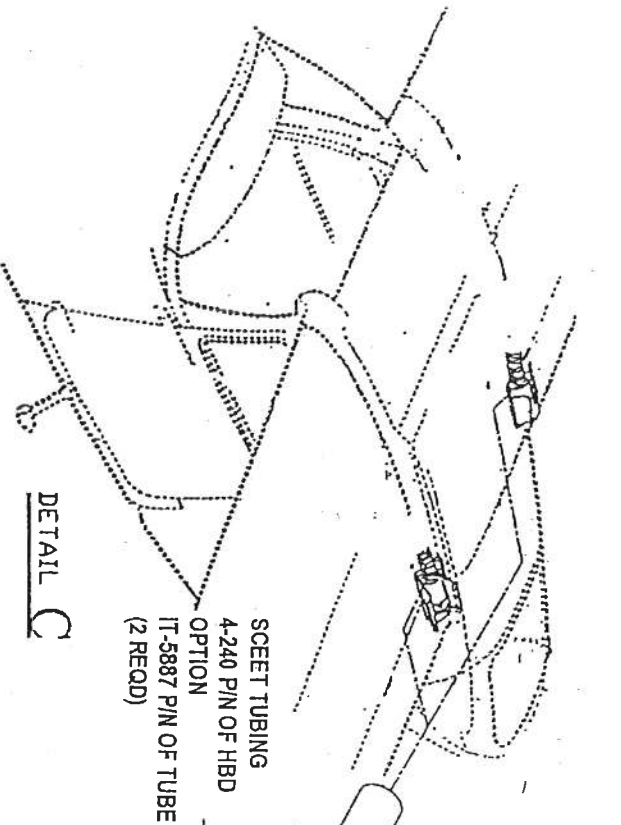

DETAIL C

- INSTALLATION OF REAR SIDE AIR VENTS
1. REMOVE EXISTING SIDE BEZEL, ORIGINAL AIR VENT AND OXYGEN OUTLET.
 2. ASSEMBLE WEMAC COMPONENTS AS SHOWN
 3. ATTACH SCHEET TUBING TO EXISTING AIR SUPPLY TUBING. REMOVE COUPLING TUBE FROM END OF SCHEET TUBE. TRIM SCHEET TUBE AS NECESSARY. REINSTALL COUPLING TUBE AND CLAMP. INSTALL COUPLING TUBE INTO EXISTING AIR SUPPLY TUBING AND CLAMP.
 4. ASSEMBLE BOX COVER AND APPLY TAPE AROUND BOX TO SEAL ALL JOINTS.
 5. ATTACH ASSEMBLED BEZEL AND WEMACS TO EXISTING STRUCTURE.
 6. PERFORM THIS INSTALLATION ON BOTH SIDES OF AIRCRAFT.

AIR VENT VALVE (4 REQD)
 055-0915-04001 P/N OF WEMAC
 OPTION
 AV 151102 P/N OF BIRK

-3 AFT CABIN VENT INTL.

REV	DATE	DESCRIPTION
1	08JAN04	REVISED
2	08JAN04	REVISED

Tolerances
 Except as noted:
 Fractional = ±1/16
 X = ±.1
 .XX = ±.05
 .XXX = ±.010
 Angular = ±2°

DESIGN TITLE	3502 W Harry Wichita, KS 67213
WILCO INC.	
AIR DISTRIBUTION BOX INSTL.	
CABIN VENT SYSTEM / CESSNA 210	
DATE	08JAN04
BY	
W210-100	
4 of 4	

